

SATURN WALL RECESSED LED FIXTURES

Class I IP44 IK08

Available in any of these RAL colors

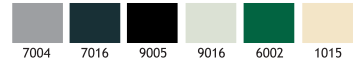

The Saturn is specially designed to deliver low glare LED lighting to steps, open areas, corridors and pathways. The fixture has a die cast aluminium body painted with electrostatic powder paint. The narrow depth of 25mm, which also includes the LED driver, allows the fixture to be installed in any wall. A plastic recessing box is included for installation into concrete. A specially developed potted power cable is used to effectively bond with the cast resin and stop any water ingress. The COB LED used comes in 2 different tones of white, 3000K and 4000K.

Body

Die cast aluminium

Paint

Electrostatic powder

Diffusers

Tempered Glass

Gaskets

Silicone

Voltage : 240V

Diffuser : Clear, Frosted And Milky Glass 4 mm

Cable : Potted 5 m 3x0,75 H03 VV-F



Asymmetrical

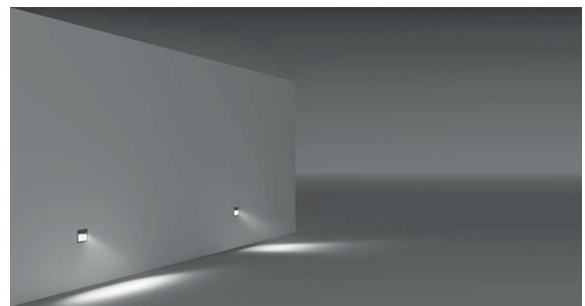
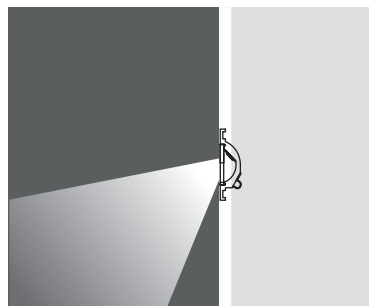

3W COB LED		Total Lighting Output	Code No
☀ Warm White	3000 K	285 lm	527001
☀ Natural White	4000 K	313 lm	527002

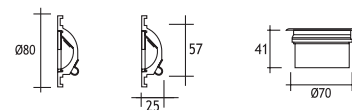

Plastic Recessing Box for Concrete

Symmetrical With Frosted Glass or Milky Glass

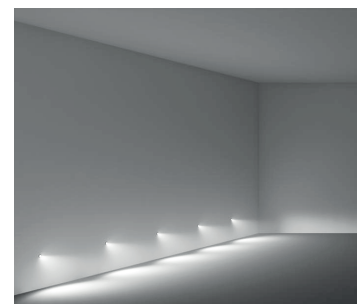
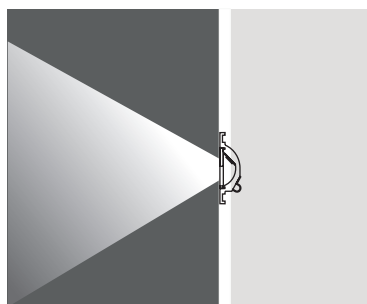

Symmetrical With Frosted Glass

3W COB LED		Total Lighting Output	Code No
☀ Warm White	3000 K	245 lm	527101
☀ Natural White	4000 K	295 lm	527102

Symmetrical With Milky Glass

3W COB LED		Total Lighting Output	Code No
☀ Warm White	3000 K	195 lm	527201
☀ Natural White	4000 K	210 lm	527202

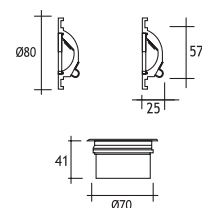

Plastic Recessing Box for Concrete