

MILET RECESSED WALK OVER FIXTURES

Load 7.5 kN | IP67 IK10

The Milet Recessed series consists of a range of LED and halogen sources to deliver the desired light effect to facades, columns, bridges, monuments, and trees. The fixtures are made of a combination of a 316L stainless steel cover and die cast aluminium body painted with electrostatic powder paint. Tempered glass, silicone gaskets and cast resin complete the fixture to make it IP67 IK10 and withstand rough environments. For the LED versions, a specially developed potted power cable is used to effectively bond with the cast resin and stop any water ingress. For the halogen versions, a PG9 cable gland allows for a secure connection of the on-site cable. A polycarbonate recessing box is included for installation into concrete or the ground. The LEDs used come in 3 different tones of white, as well as blue, red, green, amber and RGB. Several lenses from 6 to 40 degrees are available to choose from to achieve the desired the light effect.

Asymmetric LEDs

In this catalogue EMFA is introducing the tilted LED fixtures. These fixtures give an asymmetrical light output to facades, columns, bridges, monuments, and trees without losing light to the sky. The die cast aluminium body has a fixed built in tilt to allow for proper heat dissipation of the LEDs that can run up to 350mA.

- Cover**
316L Stainless Steel
- Body**
Die cast aluminium
- Recessing Box**
Polycarbonate
- Glands**
1 x PG 9
- Gaskets**
Silicone
- Diffusers**
12 mm Tempered Glass

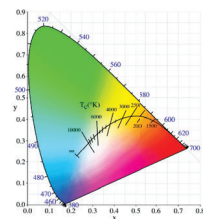

LEDs

Only highest quality LEDs such as Cree or Toplite are used in production allowing for maximum lumen output and maximum lifetime. Most LEDs run on 350mA or 700mA depending on how much light output is required. The white color temperature binning is 200K at most, and always on the same x,y coordinates on the CIE diagram in accordance with Energy Star. This ensures consistent supply of the same color temperature over time. As LEDs are constantly developing and becoming more efficient, lumen output given in this catalogue are current as of March 2020. At 2700K, 3000K, and 4000K LED lumen output per led is 110lm; at 6000K the lumen output per led is 125lm. Total Lighting Output as printed in this catalogue is the actual light output of the entire fixture. The minimum CRI of the LEDs used is 85 with a majority of products over 90.

Thermal Management

All fixtures are designed to withstand ambient temperatures of at least 50°C. The LEDs are mounted on metal core pcbs, which are mounted to the aluminium body of the fixture so that the entire fixture acts as a heat sink. Extensive testing is performed in EMFA's laboratory to ensure these values are maintained so that the lifetime of the LED is not compromised.

"Customization" is EMFA's standard

EMFA offers many combinations for each fixture, as all fixtures are made in house. A combination of 2 finishes of stainless steel, 8 LED colors, and 5 or more lenses and reflectors are available to make the fixture suitable for the required application. This is done without increasing lead-time and is available for large as well as small quantities.

AntiStheft Screws

MILET RECESSED WALK OVER FIXTURES

Load 7.5 kN | IP67 IK10

Available in any of these RAL colors

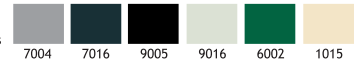

MILET 2

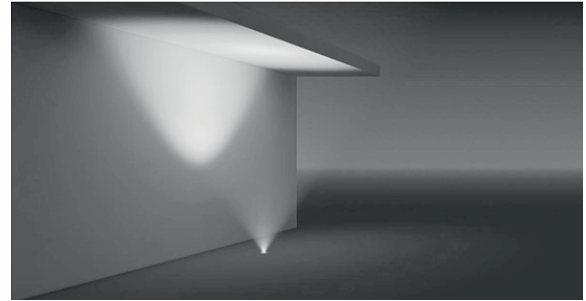
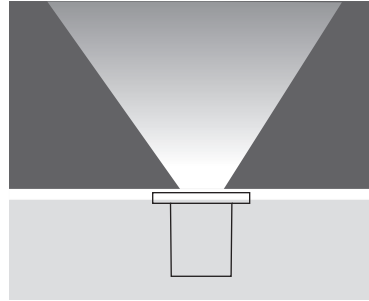

HALOGEN 12V 20-35W (10° or 38°) Code No

Lampholder : Gu4 316101

Reflector : -

Diffuser : Clear Glass

Class III

HALOGEN 240V 40W Code No

Lampholder : G9 316121

Reflector : 40°

Diffuser : Frosted Glass

Class I

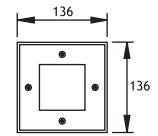

HALOGEN 12V 35W (10° or 38° or 60°) Code No

Lampholder : Gu 5.3 316111

Reflector : -

Diffuser : Clear Glass

Class III

HALOGEN 240V 50W (25° or 50°) Code No

Lampholder : Gu10 316131

Reflector : -

Diffuser : Clear Glass

Class I

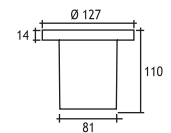

Recessing Tube

MILET 4

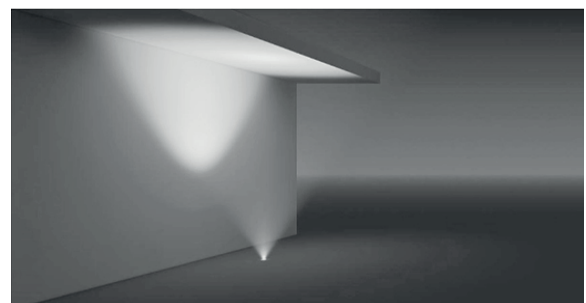
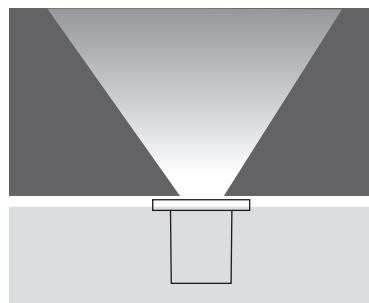

HALOGEN 12V 20-35W (10° or 38°) Code No

Lampholder : Gu4 317101

Reflector : -

Diffuser : Clear Glass

Class III

HALOGEN 240V 40W Code No

Lampholder : G9 317121

Reflector : 40°

Diffuser : Frosted Glass

Class I

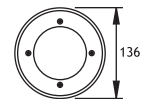

HALOGEN 12V 35W (10° or 38° or 60°) Code No

Lampholder : Gu 5.3 317111

Reflector : -

Diffuser : Clear Glass

Class III

HALOGEN 240V 50W (25° or 50°) Code No

Lampholder : Gu10 317131

Reflector : -

Diffuser : Clear Glass

Class I

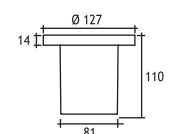

Recessing Tube

MILET RECESSED WALK OVER FIXTURES

Load 7.5 kN | IP67 IK10

Available in any of these RAL colors

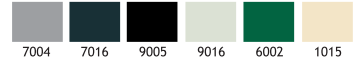

MILET 4 FLUSH MOUNTED

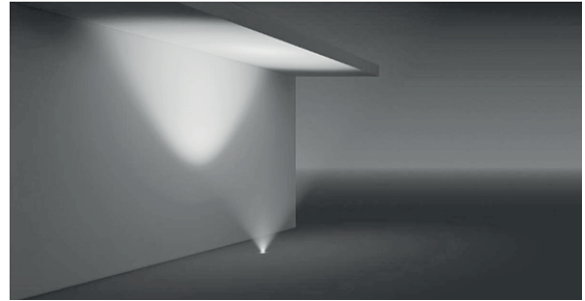
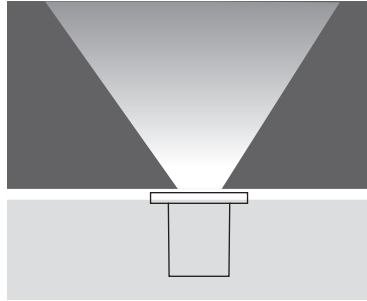

HALOGEN 12V 20-35W (10° or 38°) Code No
Lampholder : Gu4 318101
Reflector : -
Diffuser : Clear Glass
Class III

HALOGEN 240V 40W Code No
Lampholder : G9 318121
Reflector : 40°
Diffuser : Frosted Glass
Class I

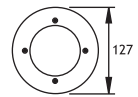

HALOGEN 12V 35W (10° or 38° or 60°) Code No
Lampholder : Gu 5.3 318111
Reflector : -
Diffuser : Clear Glass
Class III

HALOGEN 240V 50W (25° or 50°) Code No
Lampholder : Gu10 318131
Reflector : -
Diffuser : Clear Glass
Class I

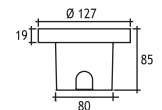

Recessing Tube

MILET 5 STEP MOUNTED

MILET 5 FLUSH MOUNTED

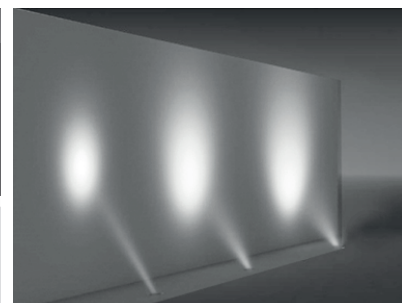
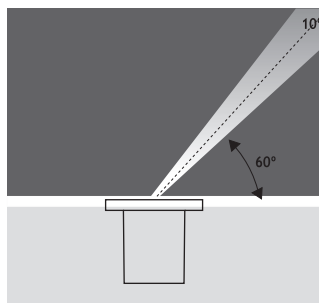

HALOGEN 12V 20W (10°)
Step Mounted Code No
Lampholder : Gu4 319101
Reflector : -
Diffuser : Clear Glass
Class III

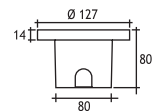
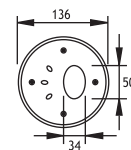

HALOGEN 12V 20W (10°)
Flush Mounted Code No
Lampholder : Gu4 319201
Reflector : -
Diffuser : Clear Glass
Class III

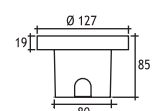
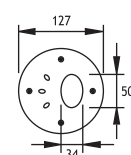

MILET RECESSED WALK OVER LED FIXTURES

Load 7.5 kN | IP67 IK10

MILET 2 LED

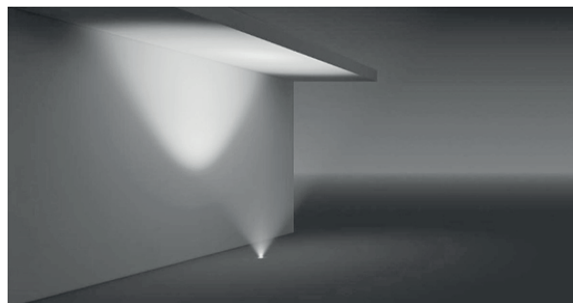
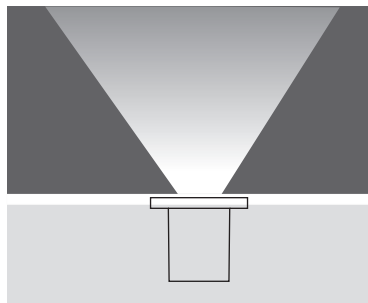

Voltage : 240V A.C with integrated driver
(12V AC or DC, 24V AC or DC on request)

Lens : 25° (10°, 15°, 40°, 6 x 25 elliptic on request)

Diffuser : 8 mm Tempered Glass
(Frosted Glass on request)

Cable : Potted 5 m 3x0,75 H03 VV-F

4 x 350 mA (4W) LED		Total Lighting Output	Code No
☀ Warm White	3000 K	340 lm	425211
☾ Natural White	4500 K	340 lm	425216
☀ Cool White	6000 K	408 lm	425217

Single color LED options upon request are ;
● Blue ● Amber ● Green ● Red

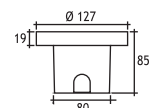
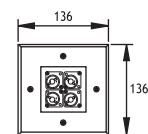

Recessing Box

MILET 4 LED

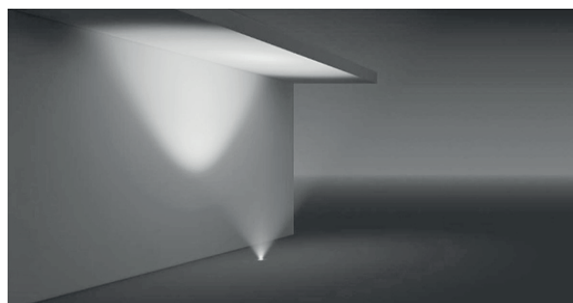
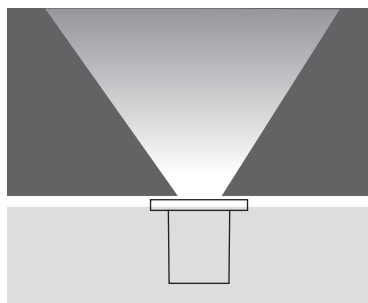

Voltage : 240V A.C with integrated driver
(12V AC or DC, 24V AC or DC on request)

Lens : 25° (10°, 15°, 40°, 6 x 25 elliptic on request)

Diffuser : 8 mm Tempered Glass
(Frosted Glass on request)

Cable : Potted 5 m 3x0,75 H03 VV-F

3 x 350 mA (3W) LED		Total Lighting Output	Code No
☀ Warm White	3000 K	225 lm	425201
☾ Natural White	4500 K	225 lm	425206
☀ Cool White	6000 K	270 lm	425207

Single color LED options upon request are ;
● Blue ● Amber ● Green ● Red

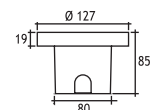
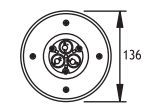

Recessing Box