

# SATURN

## WALL RECESSED LED FIXTURES

### Class I IP44 IK08

Available in any  
of these RAL colors

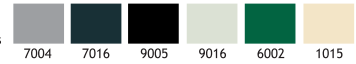

The Saturn is specially designed to deliver low glare LED lighting to steps, open areas, corridors and pathways. The fixture has a die cast aluminium body painted with electrostatic powder paint. The narrow depth of 25mm, which also includes the LED driver, allows the fixture to be installed in any wall. A plastic recessing box is included for installation into concrete. A specially developed potted power cable is used to effectively bond with the cast resin and stop any water ingress. The COB LED used comes in 2 different tones of white, 3000K and 4000K.

#### Body

Die cast aluminium

#### Paint

Electrostatic powder

#### Diffusers

Tempered Glass

#### Gaskets

Silicone

**Voltage** : 240V

**Diffuser** : Clear, Frosted And Milky Glass 4 mm

**Cable** : Potted 5 m 3x0,75 H03 VV-F



#### Symmetrical With Milky Glass

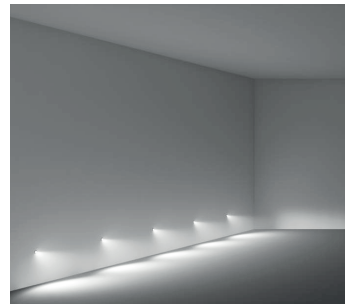
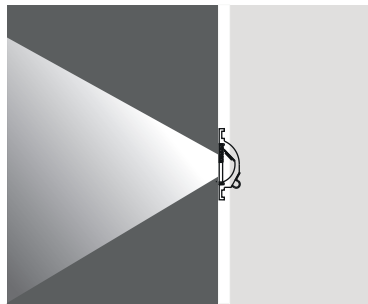

3W COB LED		Total Lighting Output	Code No
☾	Natural White 4000 K	210 lm	527202

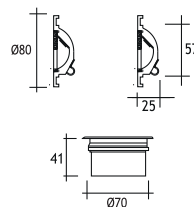

Plastic Recessing Box  
for Concrete