

# TAROS SURFACE MOUNTED LED FIXTURE

## Class II IP67

EMFA's 20mA LED fixtures are ideal for ambiance lighting outdoors and in where only a touch of light is required. These fixtures apart from being used as orientation lights, can light steps and paths and highlight walls and columns. A material mix of die cast aluminium, marine grade stainless steel and acrylic are offered to fit the correct location. A choice of lighting or backlighting LEDs is offered to either give a directional lighting effect or a lighting glow.

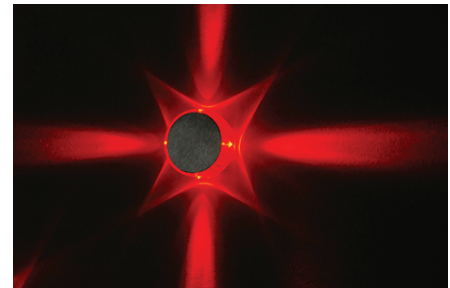

### “Customization” is EMFA’s standard

EMFA offers many combinations for each fixture, as all fixtures are made in house. A combination of 6 standard paint colors, 5 LED colors and 2 LED types are available to make the fixture suitable for the required application. This is done without increasing lead-time and is available for large as well as small quantities.

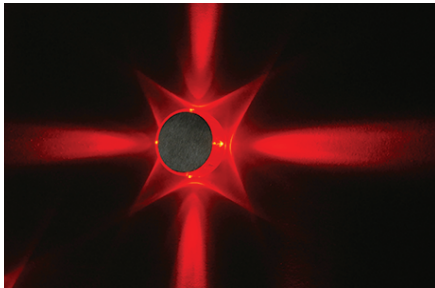

**Body**  
Acrylic  
**Cover**  
Stainless steel  
**Gear**  
Complete with Led Driver

**Voltage** : 240V A.C Class II  
(12V AC or DC, 24V AC or DC on request)  
Standard with 5m 3x0,75 H03 VV-F cable

<b>WITH LIT PERIMETER</b>		
<b>4 x 20 mA LIGHTING LEDS</b>		Code No
☀	Warm White	428101

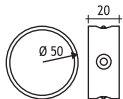

Single color LED options upon request are ;  
● Blue   ● Amber   ● Green   ● Red